

NEWS

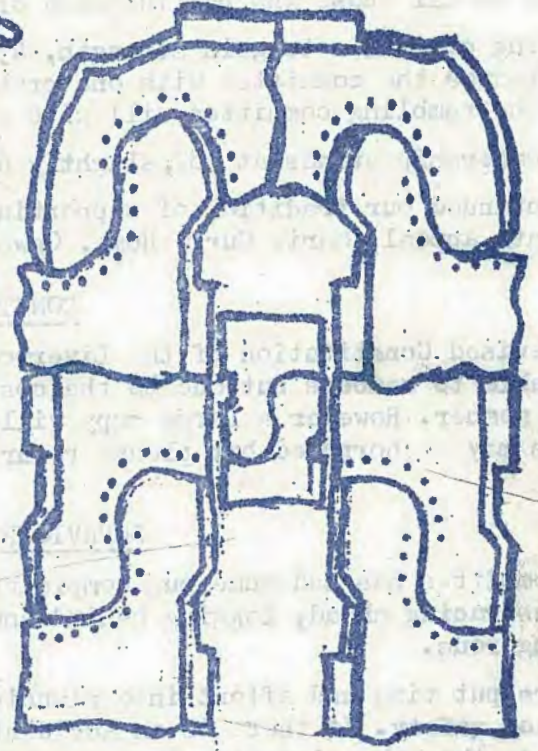

EDITORIAL

It's a pretty healthy sign that so many more people are now coming out on our rambles than just a few years ago when the average was around 31 per fortnightly ramble. In those days we had both 'A' and 'B' walks only with the occasional 'C' and I remember one full coach trip to Ullswater when a 'C' walk was proposed but only two or three people were interested, the majority wanting good 'A' and 'B' walks in that popular area. One would not believe it if the present day's trend of popularity for 'C' walks was predicted with a minority on the 'A' and 'B'. I have just heard rumours that some of the 'B' walks are too tough for the average 'B' walker forcing them to drop down to 'C' walks. Without the obvious remedy of making 'B' walks easier, providing extra leaders could be found, it might be a good practice to throw in extra 'B'-plus and 'B'-minus rambles on certain dates which would also relieve the strain on 'C' walk leaders (41 on a recent 'C' walk is just a bit too much for one person to control!). No doubt the new rambling committee will be discussing the overcrowding of 'C' walks and how to rectify the problem. The recent colder weather may be the solution, forcing people to walk faster to keep warm which is more likely to attract one on our 'B' rather than the slower 'C' walks. Anyway, whatever grade of walker you are, keep clocking up the miles on our future rambles and don't forget the social side. Keep smiling,

DAVE NEWNS

THE SECRETARIAL REPORT (AGM) 26 Sept

The past twelve months have given the committee a great deal of work. The revised Constitution took many hours and was wholly accepted at the Special General Meeting in February. The Social scene has been slightly quieter this year, though old favourites and new ideas were tackled. The new club room at the Spiral Staircase has worked out well. The Charity Dance for KIND raised almost £1200 - many thanks to all those who participated or helped organise this excellent event.

Rambling continues to gain strength, 43 rambles at an average of 49 per ramble. This leaves the committee with one problem, lack of leaders. If you fancy having a go the rambling committee will give every assistance, so give it a try.

The membership stands at 287, slightly down on last year but very good all the same.

We continued our tradition of supporting worthwhile causes. Donations went to R.A. Footpath Appeal, Marie Curie Home, Ogwen Mountain Rescue and Jospice.

CONSTITUTION

The revised Constitution of the Liverpool Catholic Ramblers Association is now available to members but due to the cost it is not intended to issue a copy to every member. However a large copy will be available at the club room for viewing. Copies may be borrowed but please return them.

BEHAVIOUR ON RAMBLES

The committee has had numerous complaints recently regarding participants on rambles racing ahead, lagging behind and disregard for the leader. This situation is dangerous.

Leaders put time and effort into planning and providing a ramble for your enjoyment and safety. If there is an accident or unforeseen circumstance and the party is delayed, then the situation is acceptable.

The incidents occurring are all avoidable if the party stays with the leader. Racing ahead, deliberate lagging behind and general disregard are all potentially dangerous, not only for those involved but also for the rest of the party. The actions of the few endangers themselves and the party and ruins the day for the majority. Please do as your leader asks, stay with the leader at all times and let's all have an enjoyable safe day's rambling.

ANTHONY BROCKWAY (retiring General Secretary)

NEW COMMITTEE (elected at recent Annual General Meeting):

Chairlady: Bernadette Doyle
Vice-Chairman: Anthony Brockway
General Secretary: Barbara Cassidy
Treasurer: Brian Keller
Registrar: Colin Molloy
Assist Registrar: Mary Whearty

General Committee: Annette Keller, Barbara Molloy, Beryl Baker, Pearl Sheils, Edna Gregory, Irene Segerberg, Ray Segerberg, Ray McIntosh, Peter Barry, Tony Bond, Ian Freeman.

THANK YOU (to Beryl)

I would like to take this opportunity to thank Beryl Baker for organising the Darts night at the Manor House pub and the ramblers that came along to join in the fun on 10th September. The girls played very well but the boys won by one game - they cheated of course. We all enjoyed the evening and I am pleased that Beryl is now to organise another one on 12th November at the same place.

IRENE SEGERBERG

PS: We are having a collection for lino for the Manor!

THANK YOU (to Bernie)

We would like to express our thanks to Bernie for all the hard work she must have put into organising the holiday to Killarney this summer. It was a memorable trip and much appreciated by all. We look forward to any future holidays that you may plan for us.

Thanks Bernie, from all who went to the Emerald Isle.

AN INVITATION to all members wishing to avail themselves to

BASIC MAP AND COMPASS INSTRUCTION

Every Monday at 2pm and 8pm in Norris Green Youth Hostel there will be instruction and advice on the above subject. Field study taken on the hoof by arrangement.

Give us a ring on 256-9144 (Joe Rourke).

oooooooooooo OOOOOO ooooooooooooo

8 Hawdon Court
Liverpool L7 6AF

Dear Friends and Ramblers,

Both Annette and I wish to thank all our friends in the LCRA, both General and Family Sections, for their kind wedding gifts and wishes.

We were extremely surprised and also greatly honoured that both sections had gone to so much trouble and expense.

It was heartwarming to see so many ramblers attending St Joseph's Church for the wedding ceremony. It was a wonderful day for both of us made more so by seeing so many friends on the day.

BRIAN and ANNETTE KELLER

oooooooooooo OOOOOO ooooooooooooo

Letter from Darryn, a child who recently went on holiday with K.I.N.D.

"To the Liverpool Catholic Ramblers Association.

Thank you for giving me a holiday at K.I.N.D. I like it at the farm with all the animals. My best thing is Archery.

From DARRYN "

Sunday, 1st September - CONISTON (Lake District)

"C" Walk - 7 miles (and I'm glad Rosa added "approx.")

As we sped up the motorway, once more making our escape from the city, Rosa handed out a splendid introduction to her walk including the following "Notes of Interest".

It is uncertain when copper was first discovered in the valley between Coniston Old Man (2,633 feet) and Wetherlan (2,502 feet) but extraction began on a large scale in the late 16th century during the Elizabethan Era. Production of copper suddenly ceased about 100 years ago due to cheaper foreign imports. The mines at Coniston were then abandoned.

On this warm summer morning, all parties left the coach at Coniston and stepped out into the day.

The "C" Party began by taking the lane at the side of the Black Bull Hotel and a gradual ascent took us into the coppermine valley (all 30 of us). Rosa led the way and informed us that this was her first attempt as leader.

Levers Water Beck and the waterfall were very popular and other walkers were abandoning rucksacks to go swimming. The temperature was getting hotter as the afternoon now unfolded. I haven't ever seen this valley so hot and dry before. The dust swirled around our boots as we walked.

We passed the old cottages, once the homes of working miners and crossed to the rear compound of the hostel. Here was something I hadn't noticed before - a small wooden enclosure displaying pictures of the area when it was a working valley. There were photographs (black and white) of the machinery and people of that day. It was all very interesting.

We climbed on in the direction of Levers Water and by this time the temperature was easily 80°F. Norman and Rosa encouraged us, saying something about "a cool breeze ahead"!!! The Levers Water (reservoir) was a delightful place to stop for an extended break and rest. We also took several photos and there was much banter as we enjoyed lunch by the waterside.

We began our descent across gentle grassy slopes and on to dry stone paths back towards Coniston. But instead of taking the usual route - directly into Coniston - Rosa continued along the lower slopes of Coniston Old Man, crossing Scrowbeck and passing Heathwaite and the hamlet of Bowmanstead. (We arrived in Coniston in time for tea).

A super walk Rosa with fine views and I'm looking forward to your next.

Norah Sheehan.

For Sale :

Amstrad Stack System (stereo) - 3 years old in splendid condition, model TS-46; includes stereo deck, stereo radio, twin deck tape and two speakers, plus record and tape cabinet (black decor). £100 o.n.o. Contact Norah Sheehan.

BOOTS (size 10), low mileage, in pristine condition, hardly used, too tight for owner therefore would suit slim feet. Any trial. Full history available. FREE to responsible owner. Contact Dave Newns - (Billinge) 0744 892791.

PS: These boots were handed to me for disposal, I'm not hanging up my boots just yet! Maybe after another 10,000 miles or so!

R A M B L E R I T E

There are a few hills in the Lake District which give maximum pleasure for a minimum of effort. Undoubtedly most walkers would put Haystacks at the top of this list. However, I have found lesser hills to be particularly well situated for fine views; Hallin Fell, Wansfell and Lattrigg give excellent value. Bill Regan and I have now found one of equally good value to add to the list:

ARNISON'S CRAG at 1424ft, stands right square overlooking the end of Ullswater from above Patterdale. Even strong winds and horizontal rain could not take from the appeal of the place. On a descent from St Sunday we decided to try something a little different and skirted Birks on the South side. Being short of time we ran a lot of the way down the steep flanks of Birks to a little ridge unremarkable in itself which is divided from Birks by a lovely valley running down through Glemara Park. The crag itself is a fine place but after a brief pause to admire the wonderful view of Ullswater and Glemara Park. And with regrets we left the unexplored scrambles and set off for Patterdale. By this time we were soaked, though warm through our exertions, and the path down being lightly trod was like a bowling green in places. This modest climb is a must for the 'C' walks in Patterdale - just high enough to be away from the midgets and flies and to freshen the atmosphere - for however pleasant a valley walk is it can rarely be described as exhilarating.

Now then, I wish to let it be known, that contrary to public opinion, I do have feelings. It was barbarously unjust of some of you to imply that I was responsible for the recent loss of 25% of a walking group. This was clearly not my fault and should, in fact, sit squarely on the shoulders of others. I would like to suggest good candidates in the form of John Henshaw and Joseph Rourke who had me callously banished from the 'A' walk; this after no-one wanted to accompany me on a 'B'. A thoroughly disappointing day as I was particularly looking forward to revisit the Nantlle Ridge.

Can I now take the opportunity to warn you that I have something special lined up for 'A' walkers on the 27th Oct (Langdales). We shall be going up Rosset Gill to Angle Tarn and on to Great End which will be tackled by its North Face, a good scramble with a small, real climb, which can be avoided. Later depending on the time available we will return via Esk Pike and Bowfell.

RAY McINTOSH

FORTHCOMING RAMBLES

Oct 20 DERWENT EDGE This is our first trip to Derbyshire in this current programme and the scenic Reservoirs of Ladybower, Derwent and possibly the Howden "Dambusters" will be circuted or sighted from Derwent Edge which is east of Derwent Reservoir. The Snake Pass (A57) Manchester-Sheffield road is an interesting coach journey but beware - there is often a problem on outward journey finding a cafe stop on this trip - so bring an extra flask of coffee or other liquid refreshment just in case. Best map is the Dark Peak 2 $\frac{1}{2}$ " to mile. Leaders A: John Henshaw, B: Tom Reilly, C: Tom Bibby.

Oct 27 LANGDALES Highly popular area of Lakeland. Usual start is from Dungeon Ghyll Car Park but 'B' or 'C' could possibly start from Skelwith Bridge or Elterwater with Bernie Doyle leading the 'C', Ian Freeman the 'B' and Ray Mc leading the 'A' as described above.

Nov 3 THE WHITE HOUSE North Wales ramble, finishing off at the White House where a meal will be taken followed by a Disco. Menu is Steak Pie, veg and trifle plus coffee at £5 per head. Coach fare is extra to this. Several visits have been made to this place by us. 'A' Brian Keller, 'C' Collin Molloy, 'B' to be arranged.

DAVE NEWNS

THE RETREAT on 24th Nov is at Sandymount, Burbobank Road, Blundellsands. It is not a ramble backwards but is a different way to spend a Sunday afternoon, starting around 1.45pm for tea and biscuits. The cost is around £3 which includes afternoon tea. Mass is included...Both General and Family Sections combine for this.

FORTHCOMING SOCIAL EVENTS

OCTOBER

- Tues 22 SMITHHILLS COACH HOUSE, Bolton. A meal with a difference - Cowboys and Cowgirls only so don't forget your ten-gallon hats! Cost is £12 which includes meal, coach and tip for the driver. The coach leaves St John's Lane at 6.30pm for 8pm meal returning approx 12-midnight. Beryl Baker is the person to see for bookings.
- Fri 25 BARN DANCE & BUFFET at Christ The King Church Hall, Queens Drive. Just £3.00. See Beryl Baker for further details.
- Thurs 31 HALLOWEEN NIGHT at the Spiral Staircase. Prizes, ducking for apples, fun and games. Beryl and Norma arranging Trick or Treat, fancy dress and lanterns. Don't forget your fancy dress and enter into the 'spirit' of the evening.

NOVEMBER

- Fri 1 BLACKPOOL LIGHTS trip, £4.00. Beryl organising (who else!).
- Thurs 7 BURNT BANGERS & MASH. A belated bonfire treat by Chris...and Beryl at the Spiral Staircase.
- Tues 12 DARTS NIGHT at the Manor House Pub, Edge Lane, 8pm. Very enjoyable on recent visit there so Beryl is organising return trip.
- Fri 15 ANNUAL BUFFET DANCE at the Everton FC Social Club. Don't see Beryl for tickets - Brian Keller is your man. Venue for the last few years and has proved to be very popular. Don't leave it too late. Tickets limited and two weeks notice is usually required for Everton FC's final numbers. Note strictly no admittance after 9.30pm (Everton's rules).
- Wed 6 (Go back 3 dates) Sequence gone to pot here but 6 Nov is.....a night off! TAMMY WYNETTE at the Empire - Beryl at the Spiral will supply you with your £12 ticket and anything else you wish to know about this theatre trip out.

DECEMBER

- Sat 7 DAY TRIP to the VICTORIANA WEEKEND at Grassington. See Colin Molloy for details of this coach outing.

Anyone interested in ICE SKATING at Deeside (date to be arranged) see Barbara Cassidy who pirouettes around the spiral staircase for your names.

Anyone with any ideas for social events please get in touch with the committee.

Any information for the next newsletter please get in touch - DAVE NEWNS, Editor.

CO-WORKERS OF MOTHER TERESA - CHRISTMAS APPEAL

A charity we have contributed to is now appealing for Christmas gifts for the homeless and elderly. They have a hostel in Seel Street. Sister Bernadatta would also like donations to purchase turkeys costing about £10 each, also gifts of mince pies for their Christmas parties on Dec 15th, 19th and 22nd. Address for contacting the Co-Workers is 51 Seel Street, L1 4AZ. Gift ideas are: Sweets, shampoos, soap, pens, combs, razors, knitted hats, and scarves, gloves for men, tights for ladies, foodstuffs, powdered milk, tea, sugar. Not required are socks and underwear for men as they have plenty in stock. If donating mince pies or foodstuffs please let Sister Bernadetta know for which party you will be bringing them to. ENTERTAINERS are also required to help out at the parties at Christmas. Again please let Sister Bernadetta know if you can help out a little nearer the date.

NEW MEMBERS Welcome to the following new members :

James Malone Margaret Pultorak Laurence Neary Dennis McCormick
Jean Taylor Mr A. J. White Jacqueline Byrne Christine Hughes
John and Laura Seagraves.

TO ALL RAMBLERS

Following problems with coach pick-up and drop-off points on Northerly routes, in future the coach will only travel up the East Lancs Road. Pick-up points will be decreed by the rambling committee and must be requested in advance. On return to Liverpool people may alight within reason but only with the permission of the leader in control. Only the leader will consult with the driver.

In the interest of all members on the coach, request your drop-off point early and ensure that you have all your personal belongings and yourself ready in plenty of time. Thank you, Rambling Committee.

TOM SHANNON in response to an appeal for more contributions to this newsletter found an article in a drawer which he has forwarded - all the way from Kingston, Jamaica (Letter dated Sept 11th). It is a sailor's yarn which possibly Joe Rourke may have seen before and very lengthy, so since this newsletter is rather full I will circulate it around the coach instead. Thanks Tom and have a nice trip back soon.

FAMILY SECTION - A MISLEADING TITLE

Enquiries from various parents wishing to bring their children on rambles are told that our Family Section does not cater for families and really is made up of older members of our club who at one time had young children out on rambles but are now all grown up, many going their separate ways. The following appeal has now been launched:

MUMS AND DADS

Are you tired of trying to take your children on suitable walks? Well join us. We intend to plan suitable exciting walks for young families from birth to 18. From now on no longer let pushchairs, feeds or irritable children stop you. Come and join us and enjoy the friendship we can give each other.

ANNE and BERNARD FOLEY

Telephone 02575 4276 (Appley Bridge).

PS: It has been suggested that families with young children should select some of our 'C' walks, coming up in their cars to join us on these 'C' walks. Possible problem with this suggestion is that many paths are too narrow to accommodate pushchairs and leaders would have to be consulted well in advance. In any event interested parents should first contact Anne and Bernard.

CHIPS NOT ALLOWED ON COACHES

Another reminder that some people are apparently unaware of the unwritten ruling that chips are not allowed on our or anyone else's coach. They are greasy, smelly, often mess upholstery up - all drivers hate them on board! Chips can be very enjoyable eaten fresh out of a container in the fresh air and containers then disposed of BEFORE entering the coach. Please co-operate.

KEN TUCKY-FRIDE

OBITUARY

Please remember in your prayers the parents of Lesley Clarke (Ron & Sheila Roberts) who both died recently. R.I.P.

SUBS NOW DUE - Another reminder to renew your annual subs (due September).... See Colin Molloy, the club's new registrar, with £4 single or £5 married couple.

FAMILY SECTION PROGRAMME. 1991.

OCT. 18/25. CHALET WEEK. Please let Peggy, Rosemary or Mona have your names for this event. The weekend itself is usually well used, but do come for the remainder of the week or whenever you can manage a day or two. It's extremely pleasant and relaxing/energetic, and very reasonably costed out. Don't miss it!!

NOV. 17. CHESTER WALK. With supreme confidence in the navigating powers of our drivers, Leo has scorned to give the route to Chester, but he and Pat will be at the Rodee Car Park (it's the big one) to start walking at NOON. There are toilets at the carpark.

NOV. 24. The ANNUAL RETREAT. This is at Sandy Mount, Burbobank Road, Blundellsands, as last year. Be there around 1.45 p.m. for tea and biscuits. Mass is included. The cost is £3 ish. It's a very stimulating and enjoyable afternoon.

DEC. 8. Lovely day on which to have a ramble! It is led by Noel and Angela. The destination is Gathurst (Shevington). There is a very prompt start at 11.30 on the dot. From the eastern roundabout at the junction of the M58 and M6 take the slip road towards Wigan. At the first traffic lights at the junction with the A577 turn left. Shortly after, at the next traffic lights turn right on to B5206 towards Shevington. After almost three miles the road descends to railway bridge controlled by traffic lights. Go through bridge and turn sharp right into approach road to station, and park.

HOUSE MEETINGS.

OCT. 3. Aimee Shawe's, 12 Greenwood Road, Allerton

NOV. 7. George and Audrey Parkinson's, 121 Alt Road, FORMBY.

DEC. 5. Tony and Molly Roche's, 16 Hillfoot Road, Liverpool, 25.

oOoOoOoOoOoOoOoOoOo

FAMILY SECTION, HEBDEN BRIDGE, 14TH JULY, 1991.

Early indications suggested a small turnout but eventually a party of twenty-seven were ready for 'the off' at the small car park in the centre of the town. Quite a cosmopolitan party it was, too. An old friend, Tony Gilmore, brought Joe, an American, and Paulo, an Italian, and we had other newcomers from Yorkshire.

We set off - uphill of course - from Nutclough, over a few stiles and came to Stoodly View where we stood and admired the view to the West - truly England's green and pleasant land. By this time we had become a long ribbon, allowing the front runners a breather while the unfortunate back markers caught up. We headed up to the Old Town, presumably once New Town, and casually walked through somebody's front and back garden to gain the road at Boston Hill.

A track now led North to Wadsworth Moor. We passed isolated farmhouses with quaint names like Slack Farm and looked down on Picket Well, the site of an old mill. The track petered out and the way was across tussocky moorland, where Aimee and Leo discovered their lost youth with a frolic in a very brackish stream, emerging with neatly dyed socks et al. Soon we came to a farmyard where sheep were gathered for clipping. The track led on to the Hebden Bridge/Howarth road. At this ^{high} point an enterprising ice-cream vendor had stationed his vehicle, and a few of us indulged in a post prandial thirst quencher - some even had ice-cream.

We crossed the road and plunged through more tussocks and cunningly hidden bogs, streams, rivulets and down a couple of steep paths to emerge at Lumb Hole Waterfall. At last, a stop for refreshments with the leader's approval. We could, at this point, have taken in Hardcastle Crags, but opted for the chicken run instead. - long walk down to Midhole and more ice-cream

Cont'd.....

FAMILY SECTION. HEBDEN BRIDGE Cont'd.

(George has shares in Walls) and a second toilet stop - what luxury!

The track ran close to Hebden Water for while and then emerged on to the road close to Hebden Bridge. A concessionary track took us through Spring Wood and soon we espied Hebden Bridge below us. The weather had been kind, the company convivial, the leader amenable, the whipper-in encouraging and so a lovely day came to a close.

It didn't actually, for a third of the party found a lovely restaurant on the way home and we had a splendid meal at a bargain price. I suppose we all found our various ways home.

GEFA.

oOoOoOoOoOoOoOoOoOoOoOoOo

RAMBLING AROUND CHESHIRE. 14TH AUGUST, 1991.

They said it was daft having a ramble in August, no-one would come. In fact, as you know, there is no fool like an old fool so seventeen old fools turned up - at the correct venue and all on time - a record in itself. A beautiful sunny day and the delightful Cheshire countryside greeted us. We began near Aldford and set off through fields lush with the year's growth - so lush in fact that it produced a new excuse for our leader when we went astray - "The path has disappeared under the plant growth since we pioneered the walk last wee". However, inspired map reading and a touch of imagination saw us through. We stopped for refreshments at a field of blue flowering plants with yellow seed heads - in fact a field of linseed, a new crop to us, showing the changes taking place in our countryside.

We skirted Farndon, a typical Cheshire small town, and headed towards the banks of the river Dee. Here we saw the Dee in one of its more peaceful and picturesque forms - not dashing among rocks as at Llangollen, not sluggishly making its way through the estuary mud-flats.

Near Farndon the river is almost hidden by trees, shrubs and wild flowers forming a hedge just allowing glimpses of the slow moving river sparkling in the sunshine. The tallest flowers were the pink Indian Balsam (also known as Policeman's Helmet from the shape of the flowers).

The river took us most of the way back to Aldford and our transport. Just one abiding memory. Mona (proving that you can teach an old dog new tricks) emulated Rose's dog Cindy and crawled under stiles and gates rather than over them - someone will have to tell her that a dog's body is a very flexible one (and, of course, Mona is no dog's body).

All in all, a lovely walk with Cheshire at it's very best. Many thanks, Gerry and Jean.

Tony and Molly.

oOoOoOoOoOoOoOoOoOoOoOoOo

SEPTEMBER 8TH WALK - WEST PENNINE MOORS.

Harry and Ronnie chose a perfect day for leading their ramble this month, near Haslingden on the West Pennine Moors.

Twenty of us arrived, after a few slight detours in getting on to the B6232, at the Clough Head Quarry Car Park. This was an ideal meeting place with its picnic tables for lunching in style, information centre, etc. and is obviously quite popular since work on an extension to the car park is under way. We're not sure where the other car occupants went though, as we hardly saw anyone in the course of the walk.

The ramble took us first across to a higher path where we turned and found ourselves overlooking the car park with little vehicles glistening in the sun. Many were envious of those wearing shorts and several 'plus four' styles became evident as trouser legs were rolled up.

After about a mile and a half we had our first stop to cool off and when our thirsts were adequately quenched, we set off to walk round the end of Calf Hey Reservoir at Haslingden Grane.

There are three reservoirs in the Grane Valley, where there was once a settlement of over one thousand three hundred people. All that remains to remind us of how the people lived here then, are the ruins of some farm buildings. The tough gritty stone in some drystone walls is evidence of the harsh type of land where they scraped a living. A second break was taken by one of these ruined dwellings in which, our leader told us, the floor below in which the animals were kept, is still intact.

At this stage Mona came round giving receipts to all who said they had paid their subs... It's a good job we are all honest or she could be out of pocket.

We continued along the Rossendale Trail crossing the well-kept stiles as we met them. Tessa managed to get herself over with more agility than we humans, but considering the heat we all did quite well.

Having rounded Calf Hey Reservoir Harry gave us the option of returning to the car park by a shorter route or continuing on round Ogden Reservoir. Ronnie and Brenda took the shorter way and the rest carried on for a few more miles. We had another short break before crossing the road and heading up towards the quarry. Eventually the car park came into sight and we descended through a new plantation of mixed trees to arrive back at about a quarter to six.

Many thanks to our leaders, Harry and Ronnie, for a most enjoyable day.

Maureen Howard.

oOoOoOoOoOoOoOoOoOoOoOo

Here are a few dates for your diaries. The first is the Ballet Swan Lake. This is at the Empire Theatre on Thursday 21st November. The very concessionary price is £6. Would you send your names and cheques made payable to Pat Pearson, 'the sooner the better' she says.

Prior to that there is another Organ Recital in the Anglican Cathedral at 3 p.m. on Saturday the 19th October. Pay at the door and the cost is between £2/3. The last one was very enjoyable.

Jumping to December, the Christmas Dinner will be at the same venue as last year. It's at the Anglican Cathedral on Saturday 21st December, but more of that in the next newsletter.

I think that's all for now, except that Bill Wilde's health has improved some and he and Kath are celebrating their ruby wedding Friday 27th September at the Everton Sports Club.

oOoOoOoOoOoOoOoOoOo

Mike and Marie Coughlan have health troubles and ask you for your prayers.